

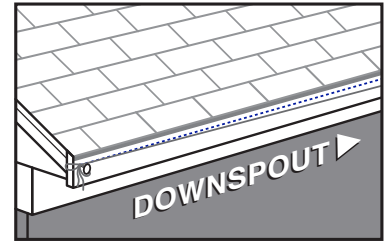

STEEL FASCIA GUTTER FASCIA GUTTER INSTALLATION

1. Preparation: Measure and mark with a chalk line

Remove old gutters and inspect fascia board and metal drip edge, repair or replace the fascia/drip edge if needed. Tack a string to the fascia board 4 or 5 inches below the roofline so that it is straight, level and taut. Drop one end of the string 1/4 inch per 10 ft., sloping toward downspout.



2. Assemble Gutter Sections

Begin assembling your gutter system on the ground starting at end furthest from the downspout. Adhere an end cap to the first piece of gutter, then join gutter sections using slip connectors secured with screws or pop rivets. Waterproof all joins with sealant, and secure with screws or pop rivets.

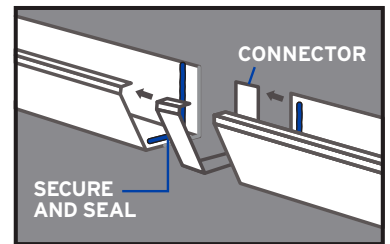

3. Hang Gutters onto the Fascia

Locate and mark the end of each rafter on the fascia board (Typically 24 inches). Use one of the following methods to hang your gutter. Be sure that the drip edge hangs into the gutter and not behind it.

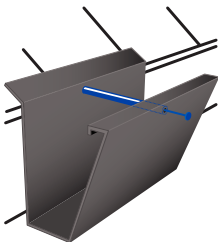

Spike & Ferrule Insert ferrule into gutter lined up with a rafter, hammer spike through gutter and drip edge into the fascia.

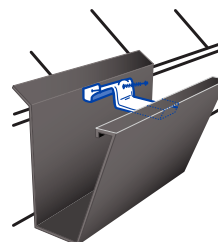

Hidden Hanger Hook the hanger under the front lip of the gutter. Drive a nail or screw through the hole in the hanger into the fascia.

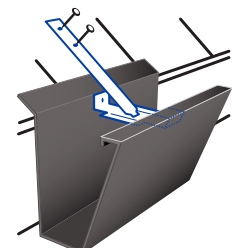

Strap Hanger Hook the hanger under the front lip of the gutter. Carefully lift shingles then nail into the roof deck.

4. Attach Mitres, Drop Outlets and Downspouts

Attach mitres to fascia board at the corners. Connect mitres to gutter with slip connectors. Secure with screws or pop rivets. Apply sealant to the inside seams to protect against leaks.

Connect elbows (a) and downspout (b) with the crimped ends pointing down. Secure the joints with screws (c). Attach the downspout to the outlet then attach an elbow at the bottom to direct rainwater away from the foundation.

Fasten downspout snugly to the wall with downspout bands.

Use 2 downspout bands for each 8-10 foot section of downspout.

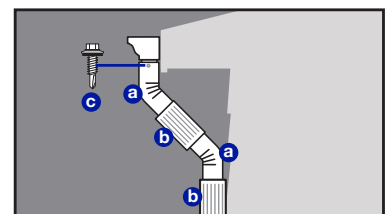
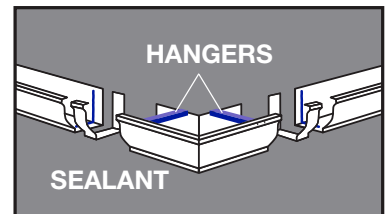

Gutter material has sharp edges. Always use leather gloves and eye protection. Working above grade is inherently dangerous, observe OSHA Regulations, Fall Protection Systems Criteria and Practices (1926.502).



CANALETA DE ACERO PARA TABLA FRONTAL

PAUTAS DE INSTALACIÓN BÁSICA

1. Retire las canaletas antiguas y revise la tabla frontal; repárela si es necesario. Fije una cuerda a la tabla frontal y establezca una línea de nivel. Baje la cuerda 2,54 cm cada 12 m, con inclinación hacia el bajante pluvial.

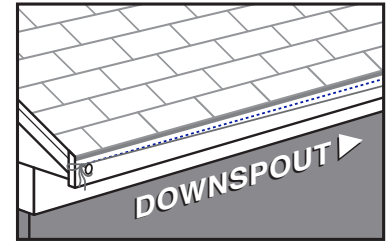

2. Comience en el extremo más alejado del bajante pluvial. Fije una tapa de extremo a la primera parte de la canaleta, luego una las secciones siguientes de la canaleta. Impermeabilice todas las uniones con sellador y fije con tornillos o remaches.

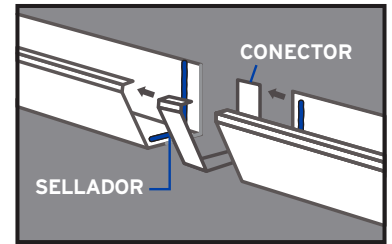

3. Cuelgue la canaleta ensamblada a la tabla frontal cada 60,96 cm.

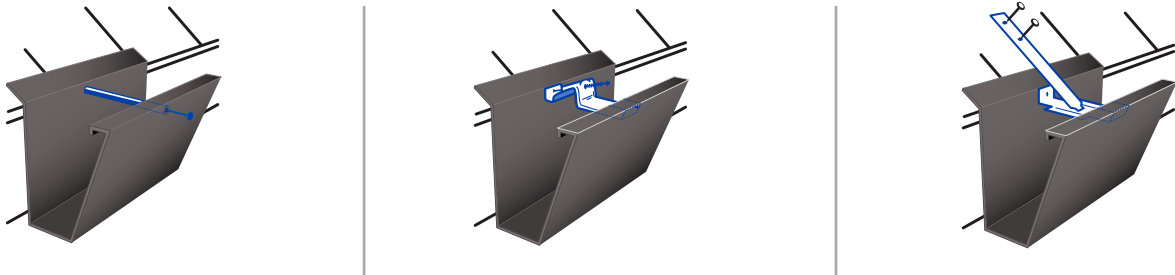

4. Coloque ingletes en las esquinas. Conecte los ingletes a la canaleta con conectores deslizantes. Fije con tornillos, soldadura o remaches. Selle con masilla. Coloque codos para bajante pluvial. Las piezas se unen colocando el extremo más grande en el extremo más pequeño aplicando fuerza entre ellos para una sujeción firme. Los bajantes pluviales deben colocarse firmemente contra la pared. Coloque el codo en la parte inferior para dirigir el agua lejos de los cimientos.

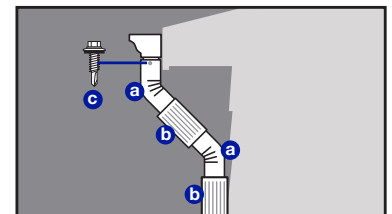
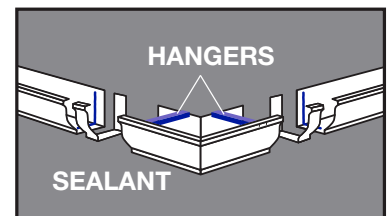

El material de la canaleta tiene bordes filosos. Siempre use guantes de cuero y lentes de protección. Trabajar en niveles superiores es inherentemente peligroso, siga la normativa de OSHA, Prácticas y Criterios de los Sistemas de Protección contra Caídas (1926.502).