

Sizing up the excavation.

The top of the **vent well** should be 4-6" above grade.

The depth of the hole should be at least 4" deeper than the bottom of the vent.

The **vent well** should be at least 4" wider than the vent opening.

The excavation should be approximately 6" larger than the **vent well**.

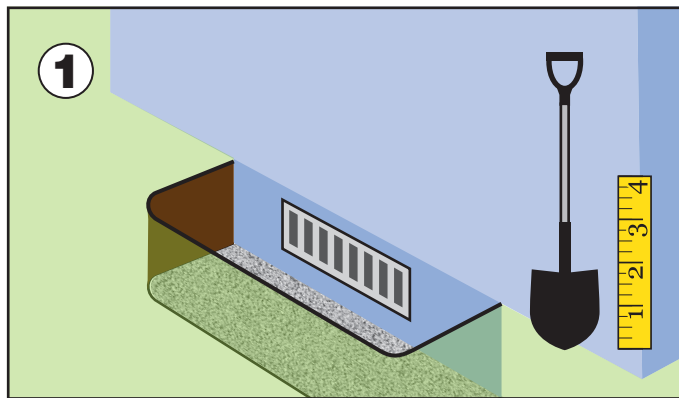

Pre-fill hole with at least 4" of gravel or drain rock to promote drainage. If flooding is a concern, connection to a perimeter drainage system might be required.

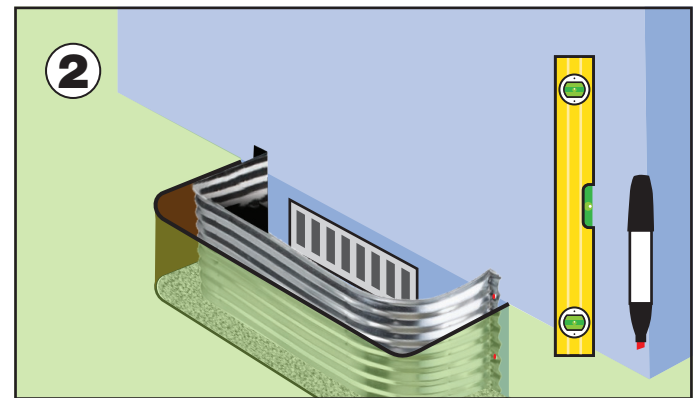

Position the vent well against the foundation and mark the location of the holes. Be sure the vent well is centered on the vent and level with the house.

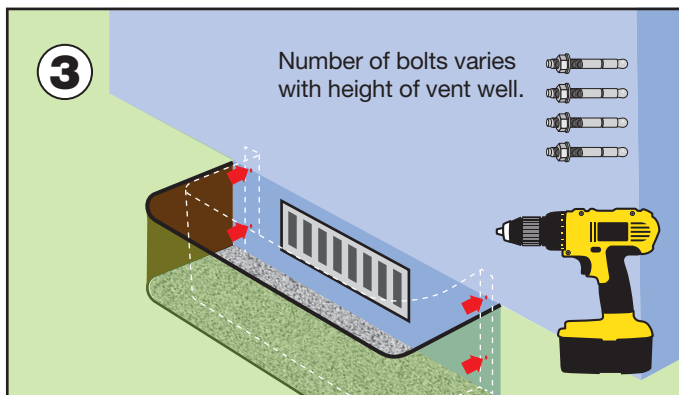

Drill holes to receive the anchor bolts, then secure the vent well to the foundation using anchor bolts and optional flat washers.

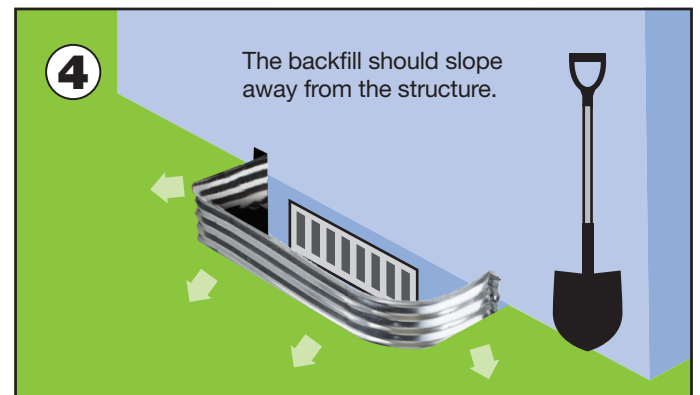

Add gravel to the well bringing the level up to 2" below the bottom of the vent opening. Backfill the area between the vent well and the hole.



CAUTION! Foundation Vent Wells have sharp edges.
When working with galvanized sheet metal or power tools, gloves and eye protection are absolutely required.

These installation guidelines are for use with typical or standard applications. It is always recommended to seek advice from a licensed professional, and to check with your local building inspector or building permit office for approvals and possible variations that may apply.

SPECIAL ORDER WINDOW & VENT WELLS

QUOTE FORM

Date: _____ Customer Name: _____

Store Number: _____ Store Location: _____ Store Contact Person: _____

Store Phone: _____ Store Fax: _____ Store eMail: _____

Notes: _____

GALVANIZED STEEL

RECTANGULAR

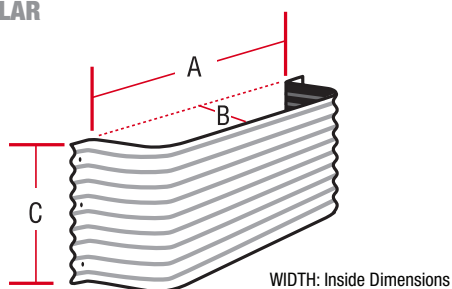

Part #	DESCRIPTION: A x B x C
<input type="checkbox"/> 553011	17 in. x 4 in. x 12 in. - 20 Gauge
<input type="checkbox"/> 553031	20 in. x 4 in. x 12 in. - 20 Gauge
<input type="checkbox"/> 553022	20 in. x 8 in. x 12 in. - 20 Gauge
<input type="checkbox"/> 553001	20 in. x 12 in. x 12 in. - 20 Gauge
<input type="checkbox"/> 553005	20 in. x 12 in. x 24 in. - 20 Gauge
<input type="checkbox"/> 563077	29 in. x 22 in. x 18 in. - 18 Gauge
<input type="checkbox"/> 563078	29 in. x 22 in. x 24 in. - 18 Gauge
<input type="checkbox"/> 563082	36 in. x 30 in. x 18 in. - 18 Gauge
<input type="checkbox"/> 563083	36 in. x 30 in. x 24 in. - 18 Gauge
<input type="checkbox"/> 563011	37 in. x 12 in. x 12 in. - 20 Gauge
<input type="checkbox"/> 563012	37 in. x 12 in. x 18 in. - 20 Gauge
<input type="checkbox"/> 563097	46 in. x 36 in. x 36 in. - 16 Gauge
<input type="checkbox"/> 563003	46 in. x 36.5 in. x 48 in. - 16 Gauge
<input type="checkbox"/> 563089	55 in. x 38 in. x 36 in. - 16 Gauge
<input type="checkbox"/> 563088	55 in. x 38 in. x 48 in. - 16 Gauge

CUSTOM w: _____ x d: _____ x h: _____ - Ga: _____

PLASTIC

RECTANGULAR

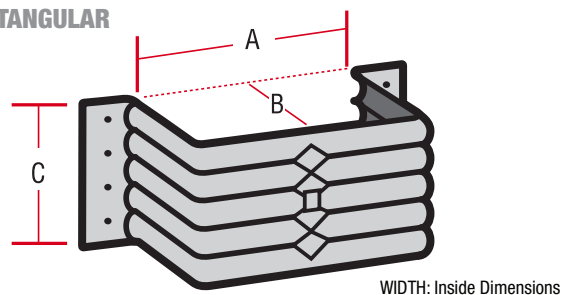

Part #	DESCRIPTION: A x B x C
<input type="checkbox"/> PFVW4LG	19 in. x 4 in. x 12 in. - Gray
<input type="checkbox"/> PFVW8LG	19 in. x 8 in. x 12 in. - Gray

CUSTOM

ARCHED - GALVANIZED STEEL

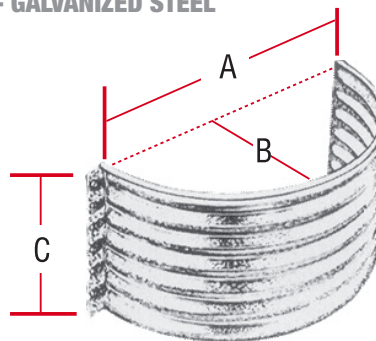

CUSTOM w: _____ x d: _____ x h: _____ - Ga: _____

1 **Select Part #** **2** **Specify Quantity** _____ **3** **FAX: 909-390-9877**

CONSTRUCTION METALS INC.

A GIBRALTAR INDUSTRIES COMPANY 

Customer Service: 800-576-9810